

PEOPLE.

PLACES.



IDEAS.

Mountain Plaza Assisted Living Casper, Wyoming

Category
Assisted Living
Memory Care

Client
Encore Partners

Project Data
62 Beds
3.35 Acres
18.5 DU/Ac.
77% Assisted Living
23% Memory Care

Services Provided
Architecture
Graphic Illustration

Financing
HUD 232

Awards
NAHB 50+ Council
Best of 50+ Housing Awards
Silver Award Winner
Best Assisted Living/Special
Needs Project "On The Boards"

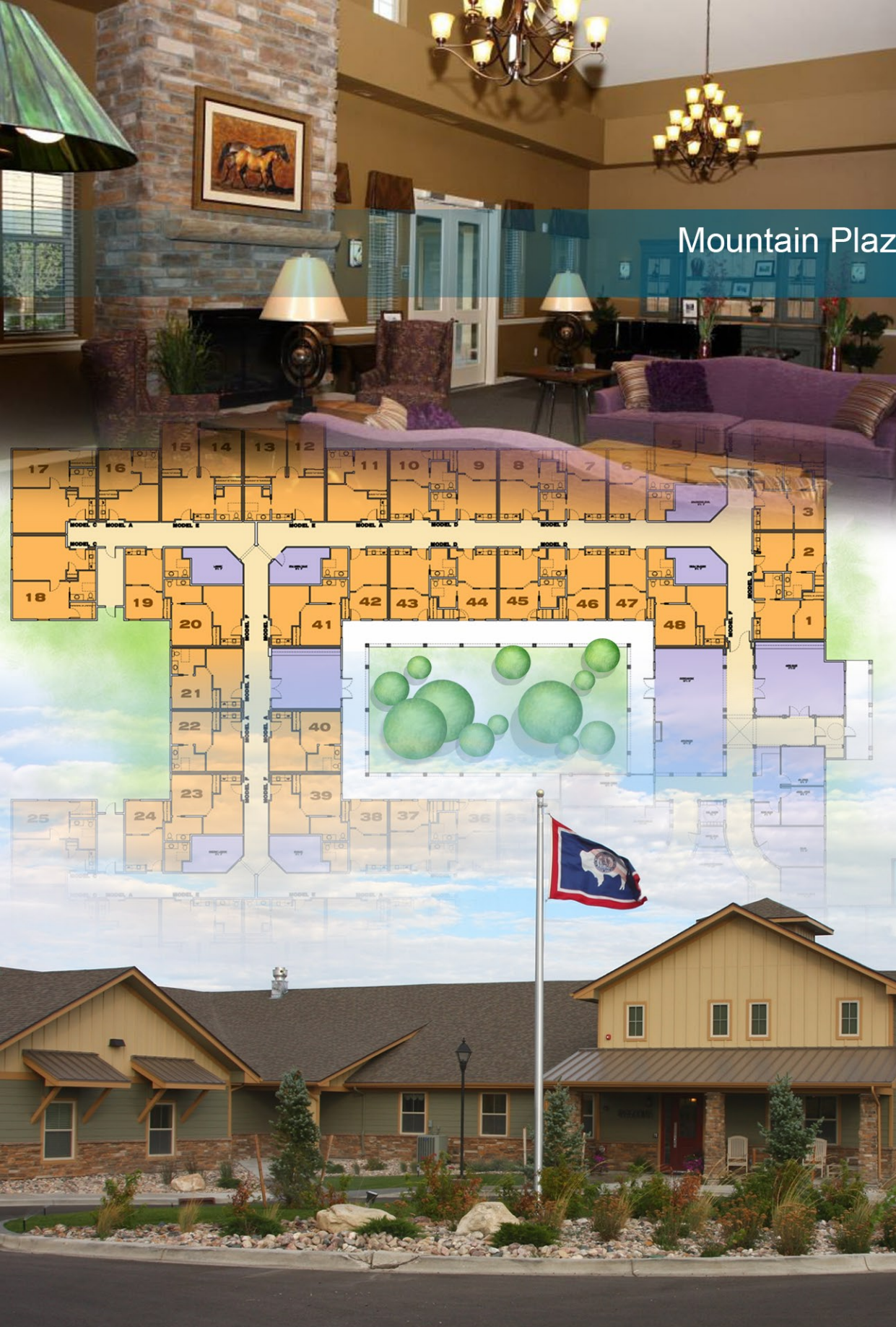

Mountain Plaza is an assisted living community located in Casper, Wyoming. The mountain-lodge character of the architecture is warm and inviting for both residents and guests. The building was thoughtfully designed around a central courtyard to give residents easy access to this amenity. The secured Memory Care neighborhood incorporates all residential components, including its own dining room, living room, activity and life skills area, and a secure garden area to allow residents to freely move from inside to out.

